

WESTSIDE

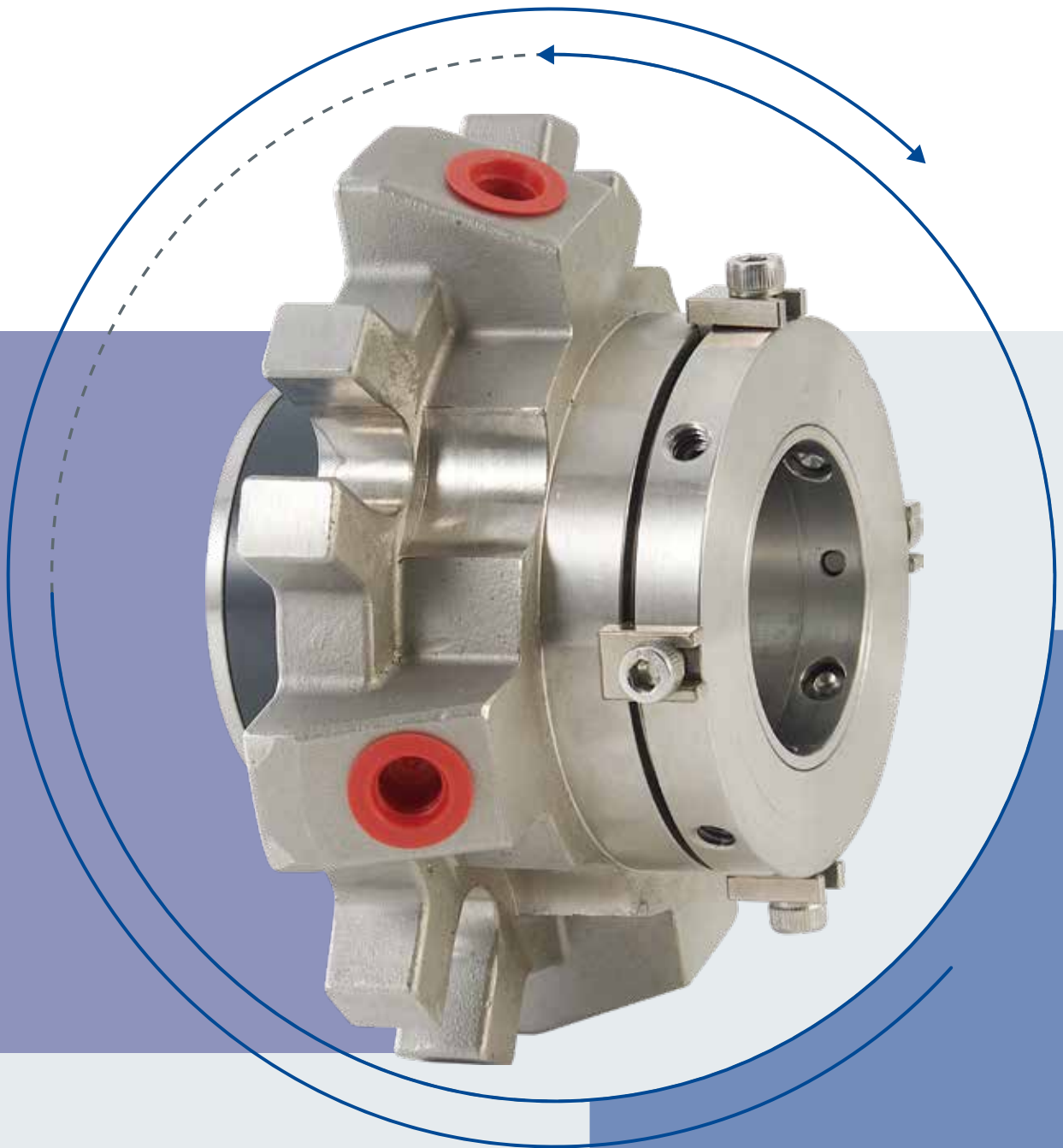

WESTSIDE CONTENT

CARTRIDGE MECHANICAL SEALS FOR PUMP TYPE

p1	FW51
p3	F390

MECHANICAL SEALS FOR AGITATORS, MIXERS AND REACTORS

p5	FEM7
p7	FEM4
p8	FOU2

MECHANICAL SEALS FOR PUMPS AND COMPRESSORS

p9	F010
p11	F040
p12	F050
p13	FM70
p14	FM7H
p15	DEF0
p16	F060
p17	F020
p18	F030
p19	FH20
p20	FLA0
p21	F5020
p22	F170
p23	FBA0
p25	F8A0
p26	F82A

SEAT TYPE

p27	S1
	S2-A
	S2-B
	S2-C
p28	S3
	S4
	S5
	Shaft Mounted
	Clamped-in

TABLE OF MATERIALS FOR MECHANICAL SEAL COMBINATION

p29	CARBON
	CARBIDE
p30	METAL
	RUBBER
	TEFLON

API 610/682 PLAN CIRCULATION SYSTEMS

p31	PLAN 1	PLAN 31
	PLAN 11	PLAN 32
	PLAN 13	PLAN 53A
	PLAN 23	PLAN 54

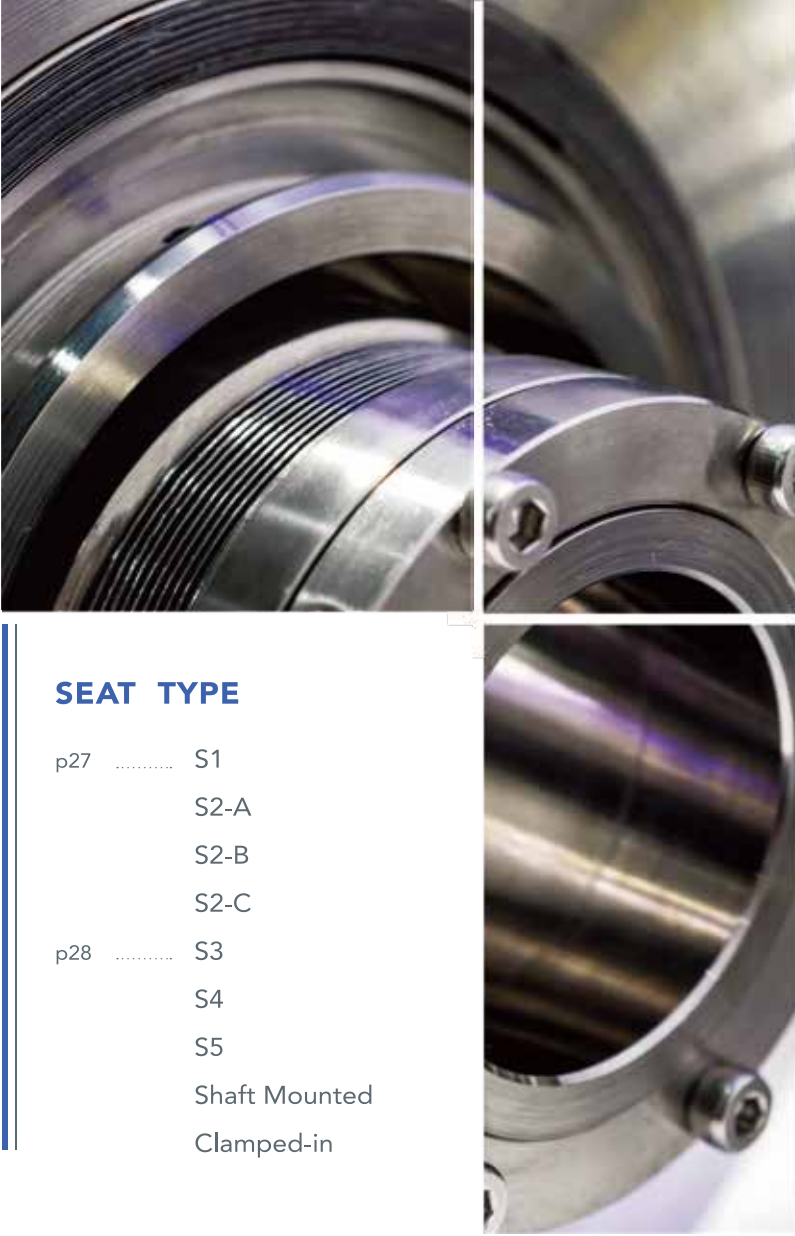

FW51

CARTRIDGE MECHANICAL SEALS FOR PUMP

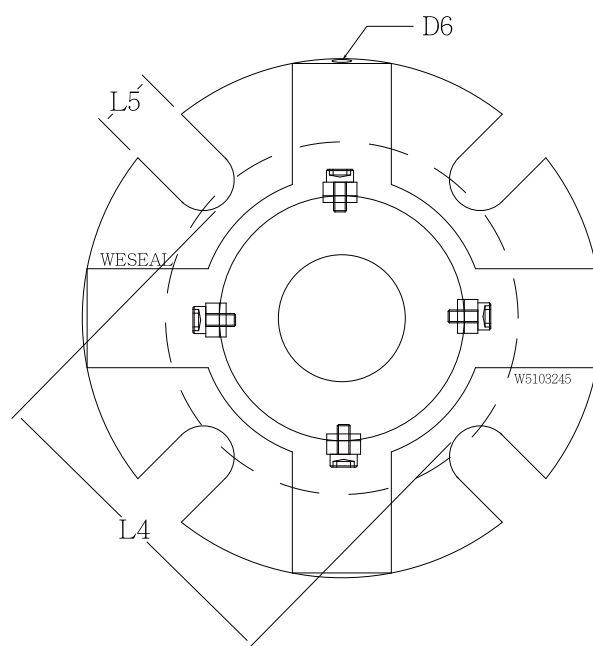
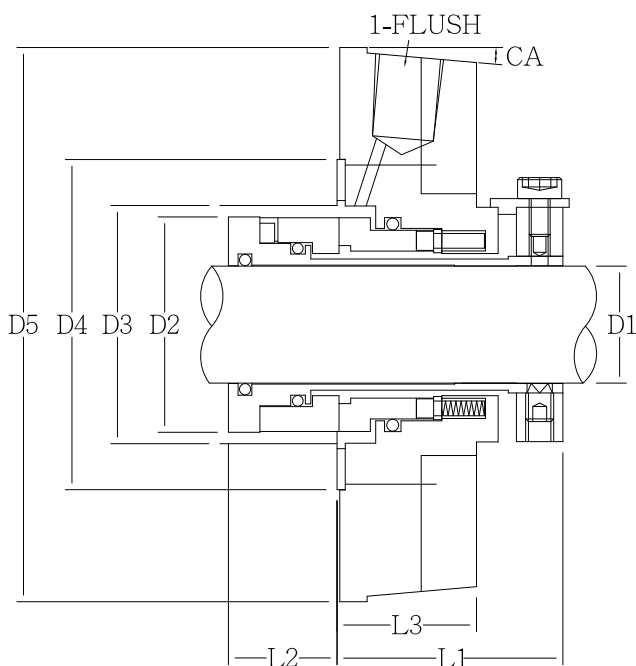

TEMPERATURE -20°C~160°C

MAX.PRESSURE 21 BAR

MAX. SPEED UP TO 24 M/S

TYPE	SHAFT				BOX BORE									
	MM	D1	D2	D3 MIN	D3 MAX	D4	D5	D6	L1	L2	L3	L4	L5	CA
FW51	25M	25.00	39.00	41.00	51.00	63.00	108.00	PT 1/4	43.00	25.00	25.4	65.00	12.00	20
FW51	28M	28.00	44.00	46.00	55.00	63.00	108.00	PT 1/4	43.00	25.00	25.4	65.00	12.00	20
FW51	30M	30.00	44.00	46.00	55.00	63.00	108.00	PT 1/4	43.00	25.00	25.4	65.00	12.00	20
FW51	32M	32.00	48.00	51.00	60.00	73.00	118.00	PT 1/4	43.00	25.00	25.4	65.00	14.00	20
FW51	35M	35.00	49.00	51.00	60.00	73.00	118.00	PT 1/4	43.00	25.00	25.4	75.00	14.00	20
FW51	38M	38.00	56.00	58.00	64.00	73.00	118.00	PT 1/4	43.00	25.00	25.4	75.00	14.00	20
FW51	40M	40.00	56.00	58.00	64.00	73.00	123.00	PT 1/4	43.00	25.00	25.4	75.00	14.00	20
FW51	45M	45.00	61.00	63.00	68.00	73.00	133.00	PT 1/4	43.00	25.00	25.4	81.00	14.00	20
FW51	50M	50.00	68.00	70.00	78.00	88.00	138.00	PT 1/4	43.00	25.00	25.4	90.00	14.00	25
FW51	55M	55.00	73.00	76.00	80.00	88.00	154.00	PT 1/4	43.00	25.00	25.4	97.00	14.00	20
FW51	60M	60.00	78.00	82.00	90.00	103.00	154.00	PT 1/4	43.00	25.00	25.4	105.00	14.00	20
FW51	65M	65.00	84.00	88.00	92.00	103.00	164.00	PT 1/4	43.00	25.00	25.4	109.00	14.00	20
FW51	70M	70.00	90.00	94.00	100.00	109.00	178.00	PT 1/4	43.00	25.00	25.4	118.00	14.00	20
FW51	75M	75.00	95.00	99.00	105.00	114.00	189.00	PT 1/4	57.00	26.00	28.0	129.00	18.00	20
FW51	80M	80.00	100.00	105.00	120.00	132.00	189.00	PT 1/4	57.00	26.00	28.0	134.00	18.00	20
FW51	85M	85.00	108.00	111.00	120.00	132.00	197.00	PT 1/4	57.00	26.00	28.0	134.00	18.00	20
FW51	90M	90.00	110.00	114.00	120.00	132.00	197.00	PT 1/4	57.00	26.00	28.0	142.00	18.00	20
FW51	95M	95.00	118.00	122.00	135.00	150.00	207.00	PT 1/4	57.00	26.00	28.0	148.00	18.00	20
FW51	100M	100.00	126.00	130.00	135.00	150.00	207.00	PT 1/4	57.00	26.00	28.0	154.00	18.00	20



FEATURE

- The rotary and balanced design tolerates high pressure
- Isolated spring design reduces potential clogging by media residue
- Integrated stationary and rotary face design reduces wear and improves stability in high-vibration applications
- Lubrication channel reduce the cost for pump casing installation
- Parts well-suited for narrow working space
- Easy installation

TYPE	SHAFT			BOX BORE		D4	D5	D6	L1	L2	L3	L4	L5	CA
	INCH	D1	D2	MINI	MAX									
		D3 MIN	D3 MAX											
FW51	1000I	25.40	39.00	41.00	51.00	63.00	108.00	PT 1/4	43.00	25.00	25.4	65.00	12.00	20
FW51	1125I	28.58	44.00	46.00	55.00	63.00	108.00	PT 1/4	43.00	25.00	25.4	65.00	12.00	20
FW51	1250I	31.75	48.00	51.00	60.00	73.00	118.00	PT 1/4	43.00	25.00	25.4	65.00	14.00	20
FW51	1375I	34.93	49.00	51.00	60.00	73.00	118.00	PT 1/4	43.00	25.00	25.4	75.00	14.00	20
FW51	1500I	38.10	56.00	58.00	64.00	73.00	118.00	PT 1/4	43.00	25.00	25.4	75.00	14.00	20
FW51	1625I	41.28	61.00	63.00	68.00	73.00	123.00	PT 1/4	43.00	25.00	25.4	75.00	14.00	20
FW51	1750I	44.45	61.00	63.00	68.00	73.00	133.00	PT 1/4	43.00	25.00	25.4	81.00	14.00	20
FW51	1875I	47.63	68.00	70.00	78.00	88.00	138.00	PT 1/4	43.00	25.00	25.4	84.00	14.00	20
FW51	2000I	50.80	68.00	70.00	78.00	88.00	138.00	PT 1/4	43.00	25.00	25.4	90.00	14.00	20
FW51	2125I	53.98	73.00	76.00	80.00	88.00	145.00	PT 1/4	43.00	25.00	25.4	97.00	14.00	20
FW51	2250I	57.15	78.00	82.00	90.00	103.00	154.00	PT 1/4	43.00	25.00	25.4	105.00	14.00	20
FW51	2375I	60.33	78.00	82.00	90.00	103.00	154.00	PT 1/4	43.00	25.00	25.4	105.00	14.00	20
FW51	2500I	63.50	84.00	88.00	92.00	103.00	164.00	PT 1/4	43.00	25.00	25.4	105.00	14.00	20
FW51	2625I	66.68	90.00	94.00	100.00	109.00	164.00	PT 1/4	43.00	25.00	25.4	109.00	14.00	20
FW51	2750I	69.85	90.00	94.00	100.00	109.00	178.00	PT 1/4	43.00	25.00	25.4	118.00	14.00	20

F390

CARTRIDGE MECHANICAL SEALS
FOR PUMP

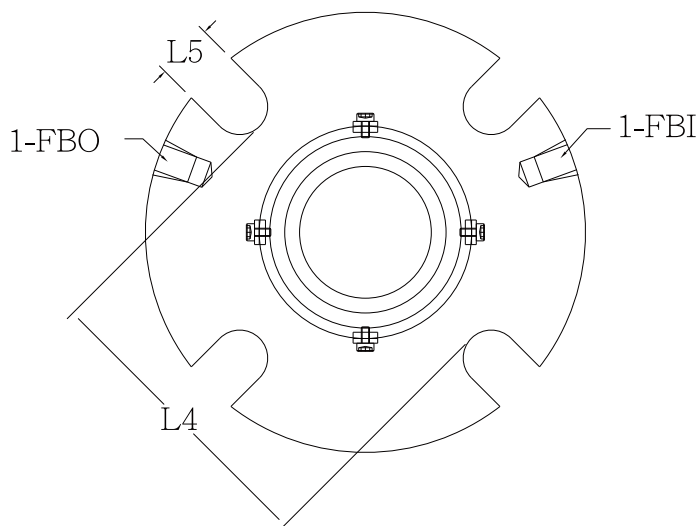
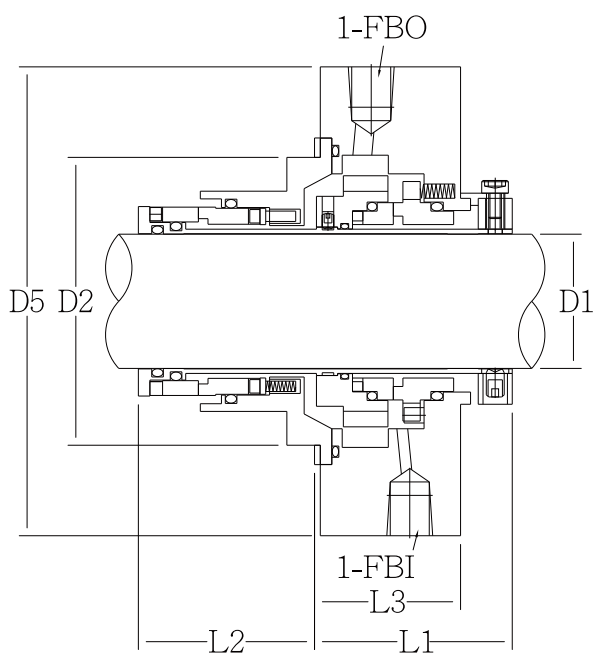

TEMPERATURE -20°C~160°C

MAX PRESSURE 21 BAR

MAX. SPEED UP TO 24 M/S

TYPE	SHAFT		BOX BORE MINI	BOX BORE MAX						
	MM	D1	D2 MIN	D2 MAX	D5	L1	L2	L3	L4	L5
F39-25M	25.0	25.0	41.0	51.0	108.0	50.5	35.0	32.0	65.0	13.0
F39-28M	28.0	28.0	45.0	55.0	108.0	50.5	35.0	32.0	65.0	13.0
F39-28M	28.0	28.0	45.0	55.0	108.0	50.5	42.0	32.0	65.0	13.0
F39-30M	30.0	30.0	48.0	57.0	108.0	50.5	42.0	35.0	65.0	13.0
F39-32M	32.0	32.0	51.0	60.0	118.0	50.5	42.0	35.0	75.0	14.0
F39-35M	35.0	35.0	51.0	60.0	118.0	50.5	42.0	35.0	75.0	14.0
F39-38M	38.0	38.0	58.0	64.0	118.0	52.5	45.0	37.0	75.0	14.0
F39-40M	40.0	40.0	58.0	64.0	118.0	53.5	45.0	38.0	75.0	14.0
F39-45M	45.0	45.0	63.0	68.0	118.0	53.5	45.0	38.0	80.0	14.0
F39-50M	50.0	50.0	70.0	78.0	138.0	54.5	45.0	39.0	87.0	14.0
F39-55M	55.0	55.0	73.0	80.0	138.0	54.5	45.0	39.0	90.0	14.0
F39-60M	60.0	60.0	82.0	88.0	138.0	54.5	45.0	39.0	98.0	14.0
F39-65M	65.0	65.0	85.0	92.0	164.0	57.5	48.0	42.0	105.0	14.0
F39-70M	70.0	70.0	95.0	105.0	158.0	62.5	53.0	47.0	115.0	14.0



FEATURE

- Dual cartridge pusher seals are commonly applied in a broad range of general-purpose industrial equipment.
- The design features a volute groove that significantly enhances the flow of barrier fluid, helping to maintain cooler operating temperatures.
- Springs are located outside the process fluid to minimize the risk of corrosion.

TYPE	SHAFT		BOX BORE MINI	BOX BORE MAX						
	INCH	D1	D2 MIN	D2 MAX	D5	L1	L2	L3	L4	L5
F39-1000I	1.000	25.40	41.0	51.0	108.0	50.5	35.0	32.0	65.0	13.0
F39-1125I	1.125	28.58	45.0	55.0	108.0	50.5	42.0	32.0	65.0	13.0
F39-1250I	1.250	31.75	51.0	60.0	118.0	50.5	42.0	35.0	65.0	14.0
F39-1375I	1.375	34.93	51.0	60.0	118.0	50.5	42.0	35.0	75.0	14.0
F39-1500I	1.500	38.10	58.0	64.0	118.0	52.5	45.0	25.4	75.0	14.0
F39-1625I	1.625	41.28	60.0	66.0	118.0	53.5	45.0	38.0	75.0	14.0
F39-1750I	1.75	44.45	63.0	68.0	118.0	53.5	45.0	38.0	80.0	14.0
F39-1875I	1.875	47.63	67.0	73.0	138.0	54.5	45.0	39.0	83.0	14.0
F39-2000I	2.000	50.80	70.0	78.0	138.0	54.5	45.0	39.0	87.0	14.0
F39-2125I	2.125	53.98	73.0	80.0	138.0	54.5	45.0	39.0	90.0	14.0
F39-2250I	2.250	57.15	82.0	88.0	138.0	54.5	45.0	39.0	98.0	14.0
F39-2375I	2.375	60.33	82.0	88.0	138.0	54.5	45.0	39.0	98.0	14.0
F39-2500I	2.500	63.50	85.0	92.0	164.0	57.5	48.0	42.0	105.0	14.0
F39-2625I	2.625	66.68	85.0	92.0	158.0	57.5	48.0	42.0	105.0	14.0
F39-2750I	2.750	69.85	95.0	105.0	158.0	62.5	53.0	47.0	115.0	14.0

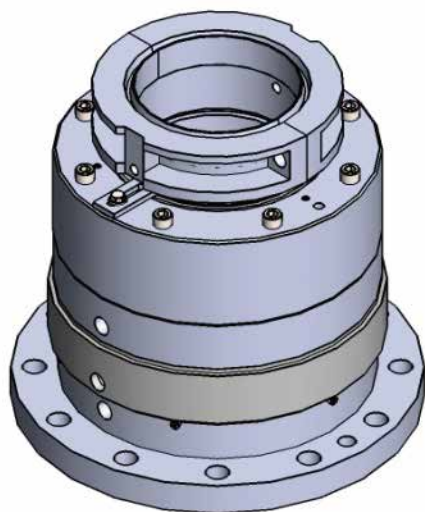

For unlisted specifications , please contact us for inquiries.

TEMPERATURE	-20°C~200°C
MAX.PRESSURE	29 KG/CM ²
MAX. SPEED	2 M/S
APPLICATIONS	Reaction Vessel
MATERIAL	Determined by the application

APPLICABLE INDUSTRIES	Applied in sealing various types of mixers, dryers, crushers, pulverizers, and reactors used in the plastics, coatings, food, and pharmaceutical industries
-----------------------	---

TYPE	SHAFT					WORKING HT.					
	MM	D2	D3	D4	D5	L	L1	E	F	X	Y
FEM7	30	120	80	150	180	212	40	3/8	1/4	8	14
FEM7	40	130	90	160	190	212	40	3/8	1/4	8	14
FEM7	50	160	100	190	220	217	40	3/8	1/4	8	14
FEM7	60	170	110	210	240	217	40	3/8	1/4	8	18
FEM7	70	200	130	240	270	232	40	3/8	1/4	8	18
FEM7	80	210	160	250	280	247	40	3/8	1/4	8	18
FEM7	90	210	170	250	280	242	40	3/8	1/4	8	18
FEM7	100	220	190	260	300	252	40	3/8	3/8	12	23
FEM7	110	240	200	280	320	257	40	3/8	3/8	12	23
FEM7	120	250	220	290	330	272	50	3/8	3/8	12	23
FEM7	130	270	230	310	350	277	50	3/8	3/8	12	23
FEM7	140	270	240	310	350	267	50	1/2	3/8	12	23
FEM7	150	280	250	320	360	272	50	1/2	3/8	12	23
FEM7	160	300	260	340	380	272	50	1/2	3/8	12	23
FEM7	170	310	270	350	390	272	50	1/2	3/8	12	23
FEM7	180	330	280	370	410	302	60	1/2	3/8	12	23
FEM7	190	350	290	390	430	302	60	1/2	3/8	12	23
FEM7	200	350	300	390	430	302	60	1/2	3/8	12	23

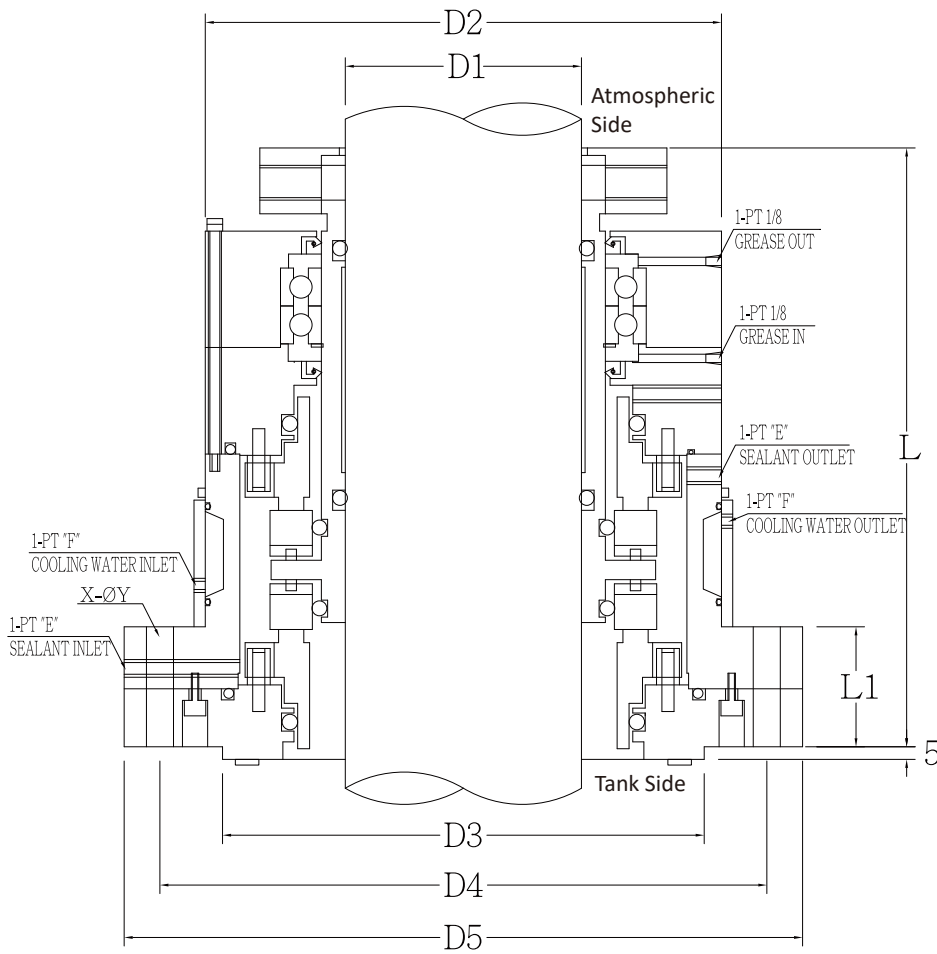

FEATURE

- Top-entry drive double mechanical seals.
- Operates regardless of rotation direction.
- Designed for medium-to-high pressure applications.
- Suitable for mixers, dryers, and mills under high-viscosity conditions.
- Suitable for large axial shaft movements.

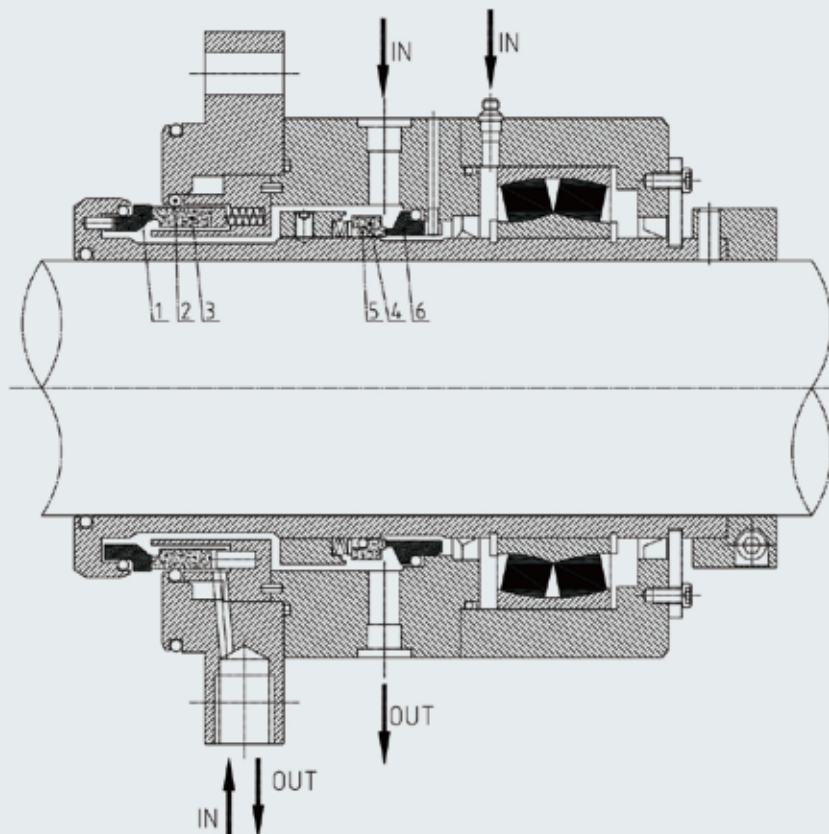

FEATURE

- Bottom entry drive double mechanical seal
- Balanced
- Operates regardless of rotation direction.
- Easy to clean, preventing product ingress into the seal area and maintaining hygienic conditions.



FEM4

MECHANICAL SEALS FOR
AGITATORS, MIXERS AND REACTORS

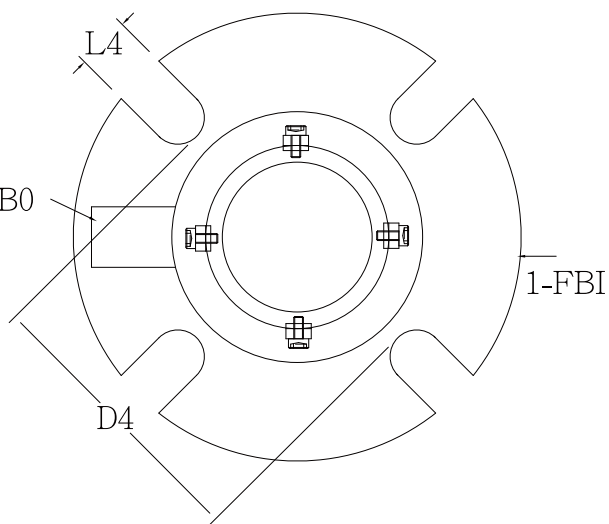
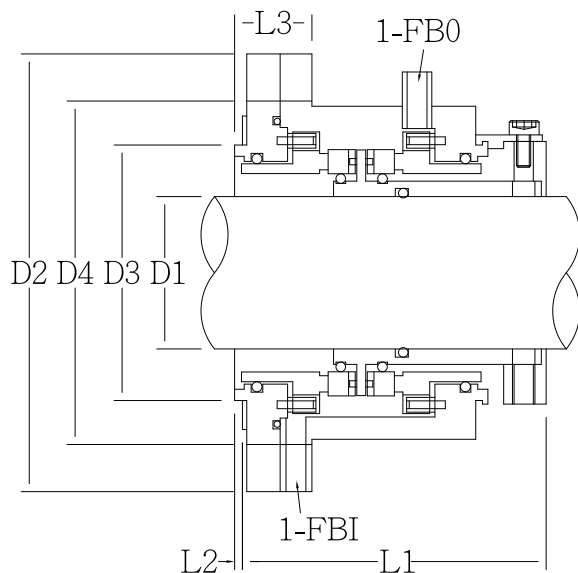

PRESSURE 25 KG/CM²

APPLICATION Top Mounting Method for Reaction Vessel

MAX.SPEED Less than 20 M/S

MATERIAL Determined by application

TYPE	SHAFT			BOX BORE		WORKING HT.				
	MM	D1	D2	D3	D4	L1	L2	L3	L4	PCS
FEM4	30	30	148	70	106.2	115	5	35	13.8	4
FEM4	35	35	153	75	111.2	115	5	35	13.8	4
FEM4	40	40	158	80	116.2	115	5	35	13.8	4
FEM4	45	45	163	85	121.2	115	5	35	13.8	4
FEM4	50	50	168	90	126.2	115	5	35	13.8	4
FEM4	60	60	178	100	132.0	115	5	35	18	4
FEM4	65	65	183	105	137	115	5	35	18	4
FEM4	70	70	188	110	142	115	5	35	18	4
FEM4	75	75	198	120	148	118	8	35	18	4
FEM4	80	80	198	120	152	118	5	35	18	4
FEM4	90	90	208	130	162	118	5	35	18	4
FEM4	95	95	218	140	182	118	5	35	18	4
FEM4	100	100	250	150	188	118	5	35	22	4
FEM4	110	110	260	160	198	123	5	35	22	4
FEM4	120	120	270	170	208	123	5	35	22	4

Larger sizes and bearing options are available upon request.

The washout hole size can be customized upon request

DIMENSION TABLE (MM SIZE)

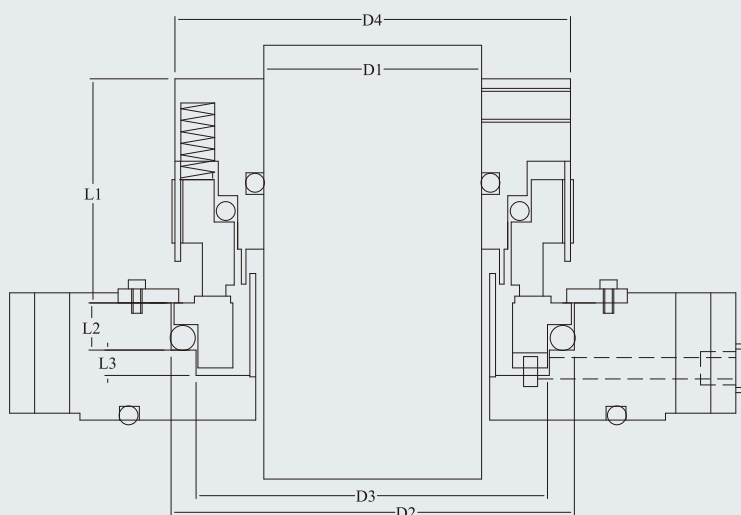

TEMPERATURE -40°C~150°C(material-dependent)

MAX. PRESSURE 325 PSI

MAX. SPEED 1000 RPM

APPLICABLE INDUSTRIES

Chemical Processing, Food Industry

APPLICABLE MACHINES

Mixer, High-pressure vertical Pump

SHAFT MISALIGNMENT

Under 1.5MM

Dry Mechanical Seal for Barrel Top or External Use.

ITEM NO	D1 SHAFT	D2	D3	D4	L1	L2	L3
	MM	MM	MM	MM	MM	MM	MM
FOU2	40.00	73.00	65.00	89.00	55.00	13.50	9.00
FOU2	50.00	83.00	75.00	98.00	55.00	13.50	9.00
FOU2	60.00	92.00	83.00	108.00	55.00	14.00	10.00
FOU2	70.00	110.00	100.00	120.00	55.00	15.00	9.00
FOU2	75.00	115.00	105.00	125.00	58.00	10.00	9.00
FOU2	80.00	120.00	110.00	130.00	55.00	15.00	9.00
FOU2	90.00	125.00	115.00	140.00	55.00	15.00	9.00
FOU2	100.00	140.00	131.00	149.00	55.00	14.50	10.00

DIMENSION TABLE (MM SIZE)

F010

MECHANICAL SEALS FOR
PUMPS AND COMPRESSORS



TEMPERATURE -20°C~180°C(material-dependent)

PRESSURE 145 PSI

MAX. SPEED 10 M/S

TEMPERATURE -20°C~180°C(material-dependent)

ITEM NO FULL SET SEALS	D1 SHAFT		D2 SEAT BORE	D3 HEAD O.D.	L1 HEAD HEIGHT	L2 SEAT HEIGHT
	INCH	MM	MM	MM	MM	MM
F0100500	0.500"	12.700	25.40	23.80	20.50	7.92
F0100625	0.625"	15.875	31.75	26.97	22.20	10.28
F0100750	0.750"	19.050	34.92	30.15	22.20	10.28
F0100875	0.875"	22.225	38.10	33.32	23.60	10.28
F0101000	1.000"	25.400	41.27	42.85	24.90	11.10
F0101125	1.125"	28.575	44.45	46.02	26.80	11.10
F0101250	1.250"	31.750	47.62	49.20	26.80	11.10
F0101375	1.375"	34.925	50.80	52.37	26.80	11.10
F0101500	1.500"	38.100	53.97	55.55	28.40	11.10
F0101625	1.625"	41.275	60.32	63.50	34.80	12.70
F0101750	1.750"	44.450	63.50	66.67	34.80	12.70
F0101875	1.875"	47.625	66.67	69.85	37.60	12.70
F0102000	2.000"	50.800	69.85	73.02	37.60	12.70
F0102125	2.125"	53.900	76.20	73.30	41.88	14.28
F0102250	2.250"	57.100	79.38	78.40	41.88	14.28
F0102375	2.375"	60.300	82.55	82.00	46.02	14.28
F0102500	2.500"	63.500	85.73	84.90	46.02	14.28
F0102625	2.625"	66.600	85.73	84.40	49.20	15.90
F0102750	2.750"	69.800	88.90	92.60	49.20	15.90
F0102875	2.875"	73.000	95.25	94.85	52.33	15.90
F0103000	3.000"	76.200	98.43	101.50	52.33	15.90
F0103250	3.250"	82.550	104.78	108.00	55.50	19.80
F0103375	3.375"	85.730	119.06	114.30	55.50	19.80

DIMENSION TABLE (INCH SIZE)

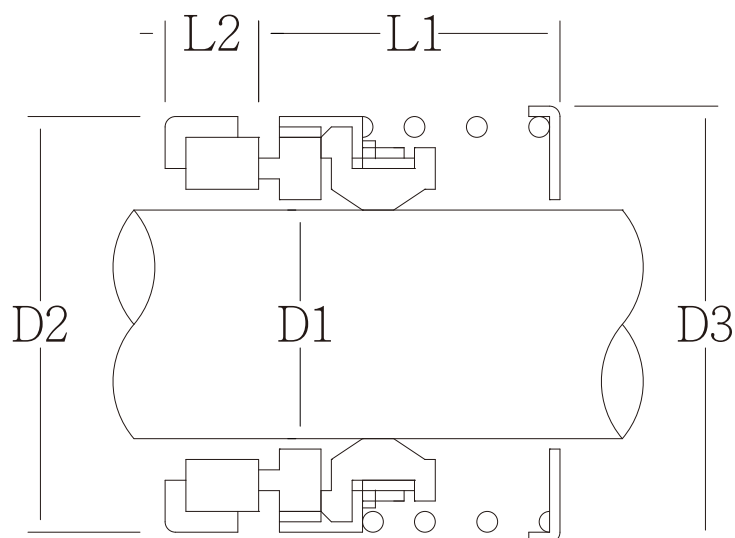

APPLICABLE INDUSTRIES

Automobile , Food Manufacturing ,
Papermaking ,
Wastewater Treatment,
Water-related Processing Industries

APPLICABLE MACHINES

Water Pumps, Centrifugal
Pumps, Rotary Pumps, Turbine
Pumps, Compressor, Stirrer and
Mixer, Blender and Mixing
Machine, Refrigeration Units
Other Rotating Shaft Machines

Stationary seats conforming to European and Japanese standards are also available.

ITEM NO	D1	D2	D3	L1	L2
FULL SET	SHAFT	SEAT BORE	HEAD O.D.	HEAD HEIGHT	SEAT HEIGHT
SEALS	MM	MM	MM	MM	MM
F01010MM	10	24.00	22.00	16.50	6.50
F01011MM	11	24.00	23.80	16.50	6.50
F01012MM	12	26.00	23.80	20.68	6.50
F01014MM	14	28.00	27.00	18.30	6.50
F01015MM	15	28.00	27.00	18.30	6.50
F01016MM	16	32.00	27.00	19.80	7.00
F01018MM	18	35.00	30.15	18.32	10.28
F01019MM	19	35.00	30.15	18.32	10.28
F01020MM	20	38.00	33.50	19.80	8.00
F01022MM	22	40.00	33.50	19.30	8.50
F01025MM	25	44.00	43.00	20.30	8.50
F01028MM	28	46.00	46.00	21.30	8.50
F01030MM	30	50.00	49.10	21.80	9.00
F01032MM	32	54.00	49.10	23.80	9.00
F01035MM	35	58.00	52.30	25.30	10.50
F01038MM	38	60.00	55.50	26.30	10.50
F01040MM	40	64.00	63.50	26.80	11.00
F01045MM	45	66.00	66.60	28.80	11.00
F01050MM	50	72.00	73.00	30.89	11.00

DIMENSION TABLE (MM SIZE)

F040

MECHANICAL SEALS FOR PUMPS AND COMPRESSORS

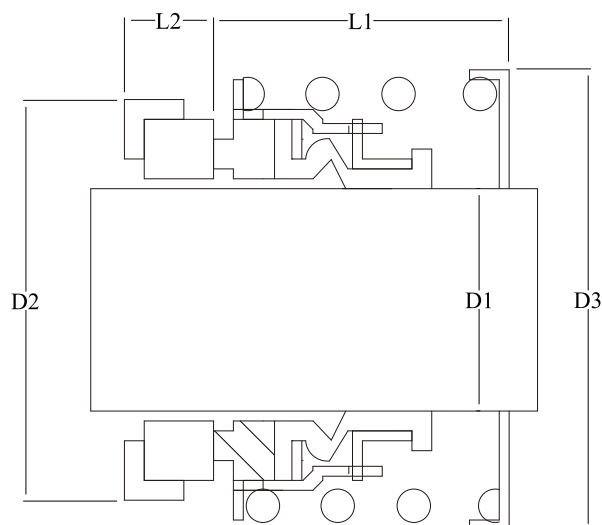

APPLICABLE INDUSTRIES

Food Manufacturing, Papermaking, Chemical and Pharmaceutical Processing, Wastewater Treatment Systems, Power Generation

APPLICABLE MACHINES

Pumps, Refrigeration Compressors, Blowers, Fans
Other rotating shaft machines

TEMPERATURE	-20°C~180°C(material-dependent)
MAX.PRESSURE	360 PSI
MAX SPEED	10 M/S

ITEM NO FULL SET SEALS	D1 SHAFT		D2 SEAT BORE	D3 HEAD O.D.	L1 HEAD HEIGHT	L2 SEAT HEIGHT
	INCH	MM	MM	MM	MM	MM
F0400625	0.625"	15.875	31.75	26.97	22.22	10.20
F0400750	0.750"	19.050	34.92	30.15	22.22	10.20
F0400875	0.875"	22.225	38.10	33.32	23.72	10.20
F0401000	1.000"	25.400	41.27	42.85	24.90	11.10
F0401125	1.125"	28.575	44.45	46.02	26.90	11.10
F0401250	1.250"	31.750	47.62	49.02	26.90	11.10
F0401375	1.375"	34.925	50.80	52.37	28.40	11.10
F0401500	1.500"	38.100	53.97	55.55	28.40	11.10
F0401625	1.625"	41.275	60.32	63.50	34.80	12.60
F0401750	1.750"	44.450	63.50	66.67	34.80	12.60
F0401875	1.875"	47.625	66.67	69.85	37.60	12.60
F0402000	2.000"	50.800	69.85	73.02	37.60	12.60
F0402125	2.125"	53.900	76.20	73.30	41.88	14.20
F0402250	2.250"	57.100	79.38	78.40	41.88	14.20
F0402375	2.375"	60.300	82.55	82.00	46.02	14.20
F0402500	2.500"	63.500	85.73	84.90	46.02	14.20
F0402625	2.625"	66.600	85.73	88.40	49.20	15.80
F0402750	2.750"	69.800	88.90	93.60	49.20	15.80
F0402875	2.875"	73.000	95.25	94.85	52.33	15.80
F0403000	3.000"	76.200	98.43	101.90	52.33	15.80

DIMENSION TABLE (INCH SIZE)

F050

MECHANICAL SEALS FOR PUMPS AND COMPRESSORS

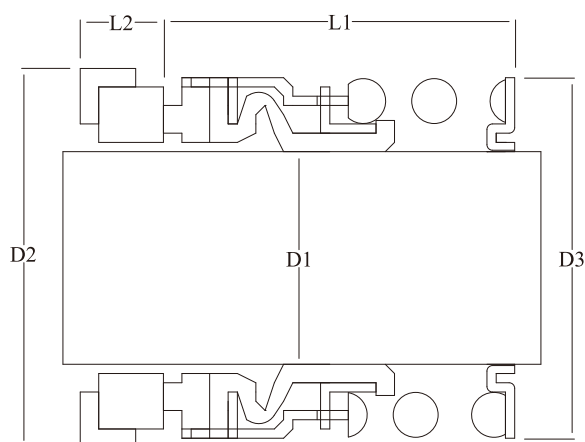

TEMPERATURE	-20°C~180°C(material-dependent)
MAX. PRESSURE	360 PSI
MAX. SPEED	10 M/S

APPLICABLE INDUSTRIES	Food Manufacturing, Wastewater Treatment Systems, Power Generation
APPLICABLE MACHINES	Pumps, Refrigeration Compressors, Blowers, Fans Other rotating shaft machines

ITEM NO FULL SET SEALS	D1 SHAFT		D2 SEAT BORE	D3 HEAD O.D.	L1 HEAD HEIGHT	L2 SEAT HEIGHT
	INCH	MM	MM	MM	MM	MM
F0400625	0.625"	15.875	31.75	31.75	33.20	10.20
F0400750	0.750"	19.050	34.92	34.92	22.20	10.20
F0400875	0.875"	22.225	38.10	38.10	35.00	10.20
F0401000	1.000"	25.400	41.27	41.27	39.00	11.10
F0401125	1.125"	28.575	44.45	44.45	41.00	11.10
F0401250	1.250"	31.750	47.62	47.62	41.00	11.10
F0401375	1.375"	34.925	50.80	50.80	42.80	11.10
F0401500	1.500"	38.100	53.97	53.97	42.80	11.10
F0401625	1.625"	41.275	60.32	60.32	50.80	12.60
F0401750	1.750"	44.450	63.50	63.50	50.80	12.60
F0401875	1.875"	47.625	66.67	66.67	53.90	12.60
F0402000	2.000"	50.800	69.85	69.85	53.90	12.60
F0402125	2.125"	53.900	76.20	76.20	60.30	14.20
F0402250	2.250"	57.100	79.38	79.38	60.30	14.20
F0402375	2.375"	60.300	82.55	82.55	63.50	14.20
F0402500	2.500"	63.500	85.73	85.73	63.50	14.20
F0402625	2.625"	66.600	85.73	85.73	69.80	15.80
F0402750	2.750"	69.800	88.90	88.90	69.80	15.80
F0402875	2.875"	73.000	95.25	95.25	73.00	15.80
F0403000	3.000"	76.200	98.43	98.43	71.40	15.80

DIMENSION TABLE (INCH SIZE)

MECHANICAL SEALS FOR PUMPS AND COMPRESSORS

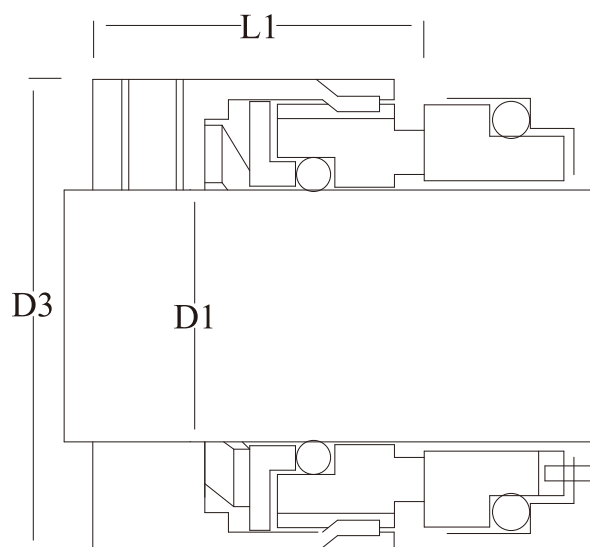

TEMPERATURE	-20°C~180°C(material-dependent)
MAX. PRESSURE	230 PSI
MAX. SPEED	20 M/S

APPLICABLE INDUSTRIES

Chemical Industry,
Food Processing, Marine Applications,
Incinerators, Papermaking Industry,
Wastewater Treatment Systems

APPLICABLE MACHINES Various Submersible Pumps, Sludge Pumps

ITEM NO	D1	D3	L1
FULL SET SEALS	SHAFT	HEAD O.D.	HEAD HEIGH
	MM	MM	MM
HM7024MM	24	39.30	28.50
HM7025MM	25	40.30	28.50
HM7028MM	28	43.30	31.00
HM7030MM	30	45.30	31.00
HM7032MM	32	47.30	31.00
HM7033MM	33	48.30	31.00
HM7035MM	35	50.30	31.00
HM7038MM	38	55.30	31.00
HM7040MM	40	57.30	31.00
HM7043MM	43	60.30	31.00
HM7045MM	45	62.30	31.00
HM7048MM	48	65.30	31.00
HM7050MM	50	67.30	32.50
HM7053MM	53	70.30	32.50
HM7055MM	55	72.30	32.50
HM7058MM	58	79.30	37.50
HM7060MM	60	81.30	37.50
HM7063MM	63	84.30	37.50
HM7065MM	65	86.30	37.50
HM7068MM	68	89.30	34.50

[illegible]

DIMENSION TABLE (MM SIZE)

FM7H

MECHANICAL SEALS FOR
PUMPS AND COMPRESSORS

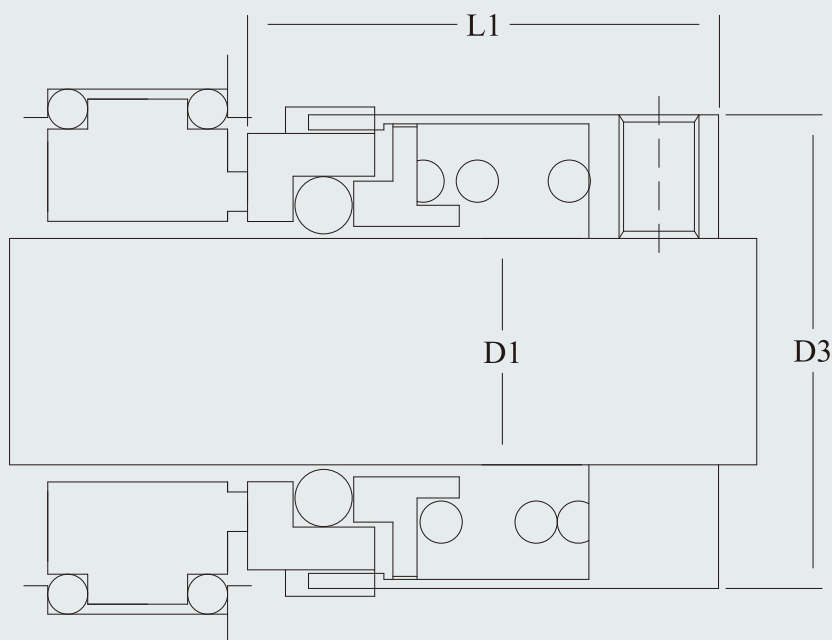

ITEM NO	D1	D3	L1
FULL SET	SHAFT	HEAD O.D.	HEAD HEIGHT
SEALS	MM	MM	MM
HM7H025M	25.00	39.60	35.00
HM7H030M	30.00	44.50	35.00
HM7H032M	32.00	46.50	35.00
HM7H035M	35.00	49.60	35.00
HM7H038M	38.00	54.00	38.00
HM7H040M	40.00	58.00	38.00
HM7H045M	45.00	63.00	38.00
HM7H050M	50.00	68.00	39.00
HM7H055M	55.00	73.00	40.00
HM7H060M	60.00	79.00	43.00
HM7H065M	65.00	86.00	45.00

DIMENSION TABLE (INCH SIZE)

TEMPERATURE	-20°C~180°C(material-dependent)
MAX.PRESSURE	230 PSI
MAX. SPEED	25 M/S
APPLICABLE INDUSTRIES	Chemical Industry, Food Processing, Marine Applications, Incinerator, Papermaking Industry, Wastewater Treatment System
APPLICABLE MACHINES	Chemical Pump

MECHANICAL SEALS FOR PUMPS AND COMPRESSORS

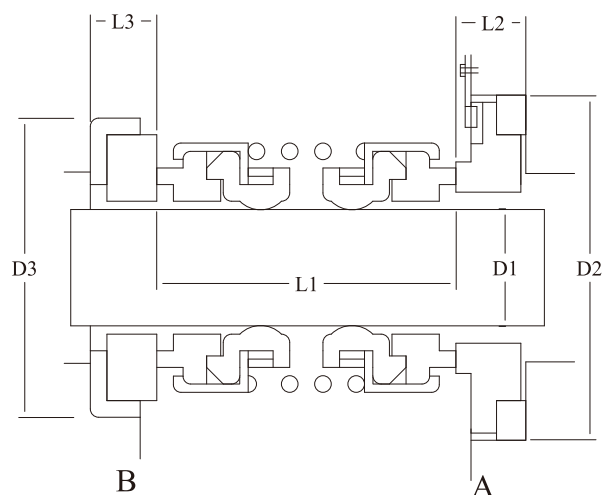

TEMPERATURE	-20°C~180°C(material-dependent)
MAX. PRESSURE	200 PSI
MAX. SPEED	10 M/S

APPLICABLE INDUSTRIES	Chemical Industry, Food Processing, Marine Applications, Incinerators, Papermaking Industry, Wastewater Treatment Systems
------------------------------	---

APPLICABLE MACHINES Various Submersible Pumps, Sludge Pumps

[illegible]

DIMENSION TABLE (MM SIZE)

F060

MECHANICAL SEALS FOR PUMPS AND COMPRESSORS

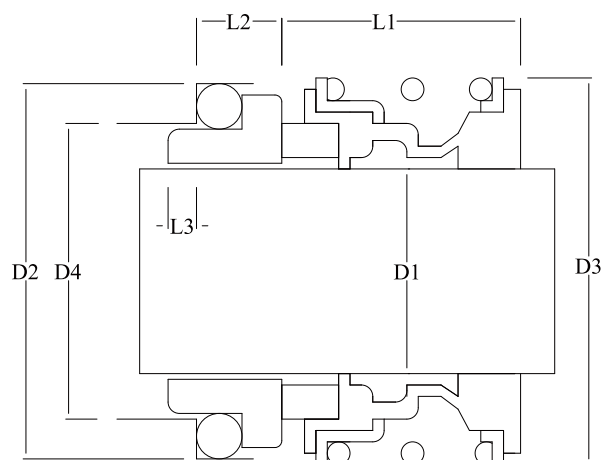

An extended tail version of the rotating seat is also available as an option.

TEMPERATURE -20°C~180°C(material-dependent)

MAX PRESSURE 174 PSI

MAX. SPEED 10 M/S

APPLICABLE INDUSTRIES

Sewage Applications,
Wastewater Treatment System

APPLICABLE MACHINES

Food Technology,
Petroleum Industry,
Petrochemical Industry

ITEM NO	D1	D2	D3	D4	L1	L2	L3
FULL SET SEALS	SHAFT	SEAT BORE	HEAD O.D.		HEAD HEIGHT	SEAT HEIGHT	
	MM	MM	MM	MM	MM	MM	MM
F06012MM	12.000	21.60	24.00	17.5	14.00	5.60	3.4
F06014MM	14.000	24.60	28.00	20.50	16.00	5.60	3.4
F06015MM	15.000	24.60	28.00	22.00	16.00	5.60	3.4
F06016MM	16.000	28.00	28.00	22.00	17.00	7.50	2.5
F06018MM	18.000	30.00	31.00	24.00	18.00	8.00	2.5
F06020MM	20.000	35.00	36.00	29.50	21.00	7.50	2.5
F06022MM	22.000	35.00	36.00	32.00	21.00	7.50	2.5
F06024MM	24.000	38.00	40.50	32.00	22.50	7.50	2.5
F06025MM	25.000	38.00	41.00	36.00	22.50	7.50	2.5
F06028MM	28.000	42.00	47.00	39.00	26.00	9.00	2.5
F06030MM	30.000	45.00	51.00	39.20	26.00	10.50	2.5
F06032MM	32.000	48.00	51.00	42.20	26.00	10.50	2.5
F06035MM	35.000	52.00	55.00	46.20	27.00	11.00	2.5
F06038MM	38.000	55.00	58.00	49.20	28.00	10.40	2.7
F06040MM	40.000	58.00	60.00	52.20	28.00	10.80	2.7
F06045MM	45.000	64.00	65.00	53.30	28.00	11.60	2.9
F06050MM	50.000	69.30	71.00	60.80	29.00	11.60	2.9
F06053MM	53.000	72.30	76.00	63.80	32.00	12.30	2.7
F06055MM	55.000	75.40	78.00	66.50	34.00	12.30	2.7
F06060MM	60.000	80.40	85.00	71.50	38.00	13.30	2.7
F06065MM	65.000	85.40	90.00	76.50	38.00	13.00	3.0
F06070MM	70.000	92.00	97.00	83.00	38.00	13.00	3.0
F06075MM	75.000	99.00	102.00	90.02	40.00	14.00	3.0

F020

MECHANICAL SEALS FOR PUMPS AND COMPRESSORS

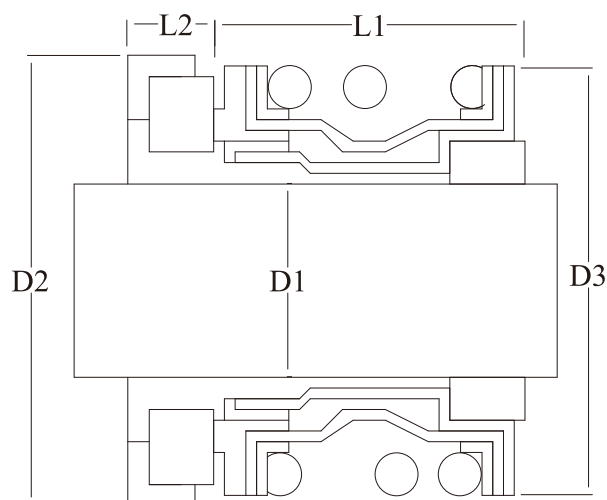

TEMPERATURE	-20°C~180°C(material-dependent)
MAX.PRESSURE	内:7.2 PSI 外:75 PSI
MAX.SPEED	5 M/S

APPLICABLE INDUSTRIES	Swimming Pool, Hot Spring, Heating and Refrigeration Industry
APPLICABLE MACHINES	Small Water Centrifugal Pumps, High-Pressure Pumps, Swimming Pool Pumps, Wastewater Pumps

[illegible]

DIMENSION TABLE (INCH SIZE)

MECHANICAL SEALS FOR PUMPS AND COMPRESSORS

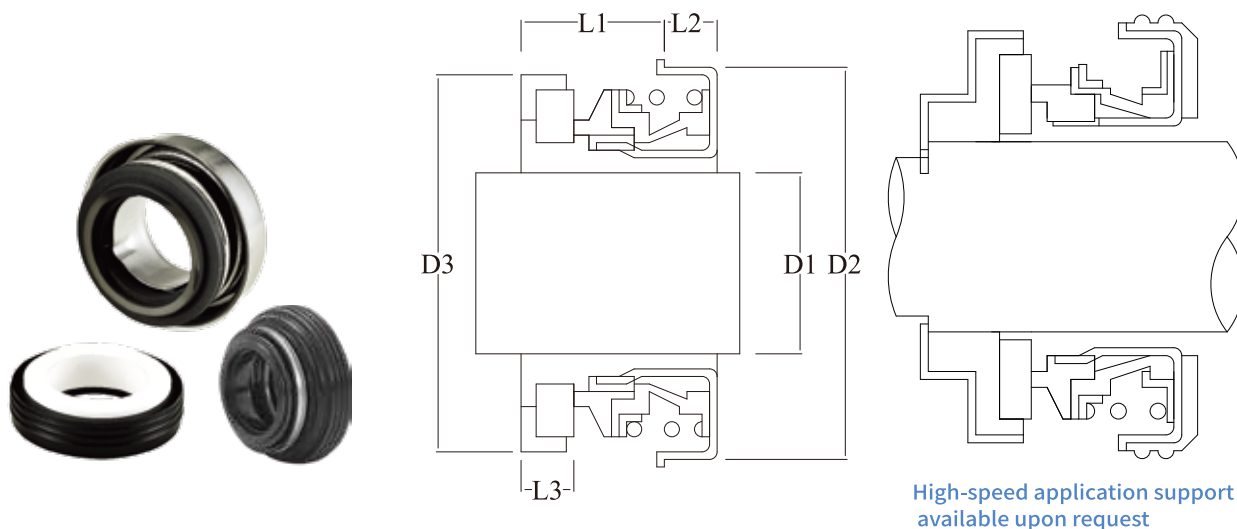

MAXIMUM SHAFT SIZE: 40mm

APPLICABLE
INDUSTRIES

Swimming Pools, Hot Springs,
Heating and Refrigeration Industries

TEMPERATURE -20°C~180°C(material-dependent)

MAX. PRESSURE 580 PSI

APPLICABLE MACHINES

Small Water Centrifugal Pumps,
High-Pressure Pumps,
Swimming Pool Pumps,
Wastewater Pumps

MAX. SPEED 10 M/S

[illegible]

DIMENSION TABLE (INCH & MM SIZE)

FH20

MECHANICAL SEALS FOR
PUMPS AND COMPRESSORS

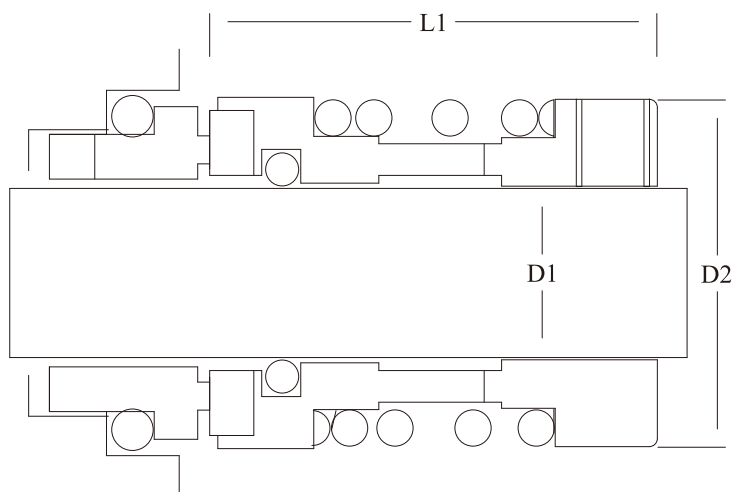

TEMPERATURE -20°C~180°C(material-dependent)

MAX.PRESSURE 170 PSI

MAX.SPEED 15 M/S

APPLICABLE INDUSTRIES

Water and Wastewater Treatment

APPLICABLE MACHINES

Chemical Industry,
Dyeing and Finishing Industry,
Shipping and Maritime Industry

ITEM NO	D1 SHAFT MM	D2 HEAD O.D. MM	L1 HEAD HEIGHT MM
HH2020MM	20.00	34.00	41.30
HH2022MM	22.00	36.00	41.30
HH2024MM	24.00	38.00	43.30
HH2025MM	25.00	39.00	43.30
HH2028MM	28.00	42.00	45.30
HH2030MM	30.00	44.00	45.30
HH2032MM	32.00	46.00	45.30
HH2033MM	33.00	47.00	45.30
HH2035MM	35.00	49.00	49.30
HH2038MM	38.00	54.00	53.30
HH2040MM	40.00	56.00	55.30
HH2042MM	42.00	58.00	55.30
HH2043MM	43.00	59.00	55.30
HH2045MM	45.00	61.00	55.30
HH2048MM	48.00	64.00	55.30
HH2050MM	50.00	66.00	60.30
HH2052MM	52.00	68.00	61.30
HH2053MM	53.00	69.00	61.30
HH2055MM	55.00	71.00	61.30
HH2058MM	58.00	76.00	63.30

ITEM NO FULL SET SEALS	D1 SHAFT MM	D2 HEAD O.D. MM	L1 HEAD HEIGHT MM
HH2060MM	60.00	78.00	63.30
HH2062MM	62.00	80.00	63.30
HH2063MM	63.00	81.00	63.30
HH2065MM	65.00	84.00	67.30
HH2068MM	68.00	87.00	67.30
HH2070MM	70.00	90.00	68.30
HH2075MM	75.00	95.00	72.30
HH2080MM	80.00	100.00	72.30
HH2085MM	85.00	107.00	77.30

DIMENSION TABLE (MM SIZE)



MAXIMUM SHAFT SIZE: 120MM

APPLICABLE INDUSTRIES

Food and Beverage Processing,
Petrochemical Industry,
Papermaking Industry,
Marine and Shipbuildings,
Wastewater Treatment
Incinerators

APPLICABLE MACHINES

Chemical Industry, Food Processing,
Marine Applications, Incinerators,
Papermaking Industry,
Wastewater Treatment Systems

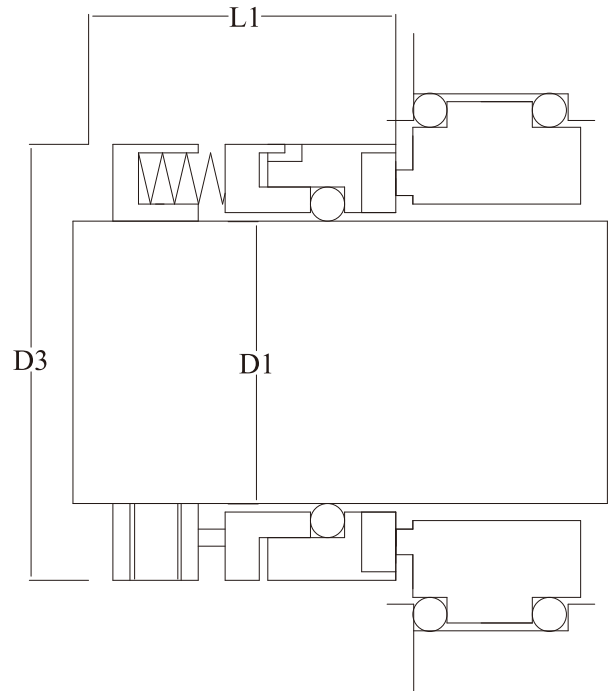

TEMPERATURE

-20°C~180°C(material-dependent)

MAX.PRESSURE

170 PSI

MAX.SPEED

25 M/S

ITEM NO	D1	D3	L1
FULL SET	SHAFT	HEAD O.D.	HEAD HEIGHT
SEALS	MM	MM	MM
HLA020MM	20.00	34.00	35.00
HLA022MM	22.00	36.00	35.00
HLA024MM	24.00	38.00	35.00
HLA025MM	25.00	39.00	35.00
HLA028MM	28.00	42.00	35.00
HLA030MM	30.00	44.00	35.00
HLA032MM	32.00	46.00	35.00
HLA033MM	33.00	47.00	35.00
HLA035MM	35.00	49.00	35.00
HLA038MM	38.00	54.00	38.00
HLA040MM	40.00	56.00	38.00
HLA042MM	42.00	58.00	38.00
HLA043MM	43.00	59.00	38.00
HLA045MM	45.00	61.00	38.00
HLA048MM	48.00	64.00	38.00
HLA050MM	50.00	66.00	39.00
HLA052MM	52.00	68.00	40.00
HLA053MM	53.00	69.00	40.00
HLA055MM	55.00	71.00	40.00
HLA058MM	58.00	76.00	41.00

ITEM NO	D1	D3	L1
FULL SET	SHAFT	HEAD O.D.	HEAD HEIGHT
SEALS	MM	MM	MM
HLA060MM	60.00	78.00	41.00
HLA062MM	62.00	80.00	41.00
HLA063MM	63.00	81.00	41.00
HLA065MM	65.00	83.00	41.00
HLA068MM	68.00	86.00	41.00
HLA070MM	70.00	90.00	42.00
HLA075MM	75.00	95.00	42.00
HLA080MM	80.00	100.00	42.00
HLA085MM	85.00	105.00	43.00
HLA090MM	90.00	110.00	45.00

DIMENSION TABLE (MM SIZE)

F5020

MECHANICAL SEALS FOR PUMPS AND COMPRESSORS

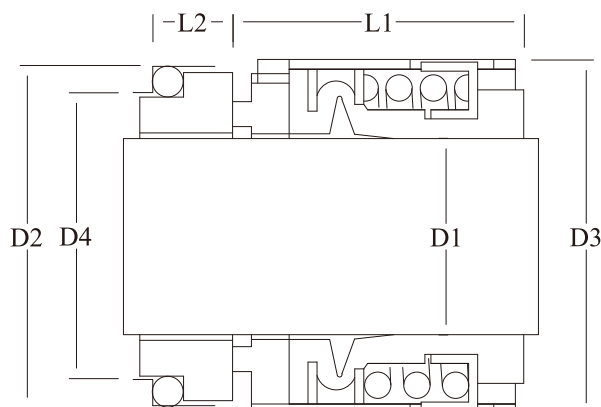

APPLICABLE INDUSTRIES

Petrochemical Industry,
Food Manufacturing Industry,
Seawater Desalination,
Printing and Ink Industry,
Chemical Pharmaceuticals,
Power Generation, Papermaking

TEMPERATURE -20°C~180°C (material-dependent)

MAX. PRESSURE 580 PSI

MAX. SPEED 10 M/S

APPLICABLE MACHINES

Pumps, Seawater Equipments,
Mixers, Low-Temperature Equipments,
Various Compressors,
Circulation Systems

ITEM NO	D1	D2	D3	D4	L1	L2
FULL SET	SHAFT	SEAT BORE	HEAD O.D.		HEAD HEIGHT	SEAT HEIGHT
SEALS	MM	MM	MM	MM	MM	MM
F502025MM	25.000	40.00	39.00	34.00	27.00	12.80
F502028MM	28.000	43.00	42.00	37.00	30.00	12.30
F502030MM	30.000	45.00	44.00	39.00	30.50	11.80
F502032MM	32.000	48.00	46.00	42.00	30.50	11.80
F502033MM	33.000	48.00	47.00	42.00	30.50	11.80
F502035MM	35.000	50.00	49.00	44.00	30.50	11.80
F502038MM	38.000	56.00	54.00	49.00	32.00	12.80
F502040MM	40.000	58.00	56.00	51.00	32.00	12.80
F502043MM	43.000	61.00	59.00	54.00	32.00	12.80
F502045MM	45.000	63.00	61.00	56.00	32.00	12.80
F502048MM	48.000	66.00	64.00	59.00	32.00	12.80
F502050MM	50.000	70.00	66.00	62.00	34.00	13.30
F502053MM	53.000	73.00	69.00	65.00	34.00	13.30
F502055MM	55.000	75.00	71.00	67.00	34.00	13.30
F502058MM	58.000	78.00	78.00	70.00	39.00	13.30
F502060MM	60.000	80.00	80.00	72.00	39.00	13.30

DIMENSION TABLE (MM SIZE)

F170

MECHANICAL SEALS FOR PUMPS AND COMPRESSORS



TEMPERATURE	-20°C~180°C(material-dependent)
MAX. PRESSURE	145 PSI
MAX. SPEED	10 M/S

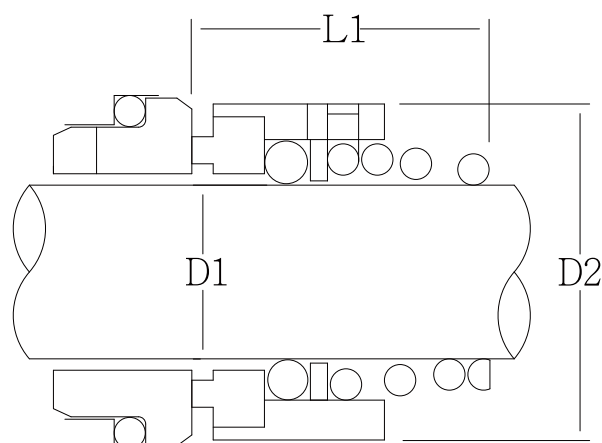
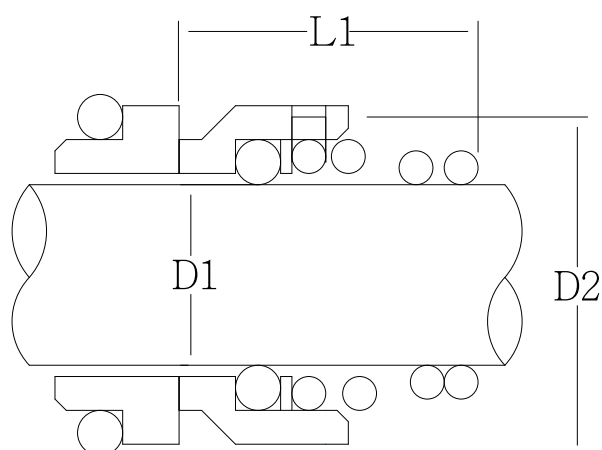

ITEM NO	D1	D2	L1
FULL SET	SHAFT	HEAD O.D.	HEAD HEIGHT
SEALS	MM	MM	MM
F17012MM	12.000	21.00	17.40
F17014MM	14.000	23.00	17.40
F17015MM	15.000	24.00	17.40
F17016MM	16.000	26.00	19.50
F17018MM	18.000	29.00	20.50
F17020MM	20.000	31.00	22.00
F17022MM	22.000	33.00	23.50
F17024MM	24.000	35.00	25.00
F17025MM	25.000	36.00	26.50
F17028MM	28.000	40.00	26.50
F17030MM	30.000	43.00	25.00
F17032MM	32.000	46.00	28.50
F17035MM	35.000	49.00	28.50
F17038MM	38.000	53.00	32.20
F17040MM	40.000	56.00	34.70
F17045MM	45.000	61.00	39.20
F17050MM	50.000	66.00	45.70
F17055MM	55.000	71.00	49.00
F17060MM	60.000	78.00	53.00
F17065MM	65.000	84.00	54.30
F17070MM	70.000	90.00	56.30
F17075MM	75.000	98.00	56.30

APPLICABLE INDUSTRIES	Sewage Applications, Wastewater Treatment Systems
APPLICABLE MACHINES	Heat treatment and water-circulation pumps, Clean water pumps, Wastewater pumps, Submersible pumps, Chemical pumps, Thermal oil pumps.



TEMPERATURE	-20°C~180°C(material-dependent)
MAX. PRESSURE	200PSI
MAX.SPEED	10 M/S

APPLICABLE INDUSTRIES

Wastewater Treatment Systems,
Food Manufacturing,
Chemical Pharmaceuticals,
SPA and Hot Springs

ITEM NO	D1 SHAFT	D2 SEAT BORE	D3 HEAD O.D.	L1 HEAD HEIGHT	L1A HEAD HEIGHT	L1B HEAD HEIGHT	L2 SEAT HEIGHT
FULL SET SEALS	MM	MM	MM	MM	MM	MM	MM
FBA010MM	10.00	21.00	20.00	15.20	27.70	35.20	5.00
FBA012MM	12.00	23.00	22.00	15.20	26.70	34.20	6.00
FBA014MM	14.00	25.00	24.00	15.20	29.20	34.20	6.00
FBA015MM	15.00	26.00	25.00	15.20	29.20	34.20	6.00
FBA016MM	16.00	27.00	26.00	15.20	29.20	34.20	6.00
FBA018MM	18.00	33.00	32.00	20.20	31.70	39.20	6.00
FBA020MM	20.00	35.00	34.00	20.20	31.70	39.20	6.00
FBA022MM	22.00	37.00	36.00	20.20	31.70	39.20	6.00
FBA024MM	24.00	39.00	38.00	20.20	34.20	44.20	6.00
FBA025MM	25.00	40.00	39.00	20.20	34.20	44.20	6.00
FBA028MM	28.00	43.00	42.00	26.20	36.70	44.20	6.00
FBA030MM	30.00	45.00	44.00	26.20	35.70	43.20	7.00
FBA032MM	32.00	48.00	46.00	26.20	35.70	48.20	7.00
FBA033MM	33.00	48.00	47.00	26.20	35.70	48.20	7.00
FBA035MM	35.00	50.00	49.00	26.20	34.70	47.20	8.00
FBA038MM	38.00	56.00	54.00	30.20	37.20	47.20	8.00
FBA040MM	40.00	58.00	56.00	30.20	37.20	47.20	8.00
FBA043MM	43.00	61.00	59.00	30.20	37.20	52.20	8.00
FBA045MM	45.00	63.00	61.00	30.20	37.20	52.20	8.00

DIMENSION TABLE (MM SIZE)

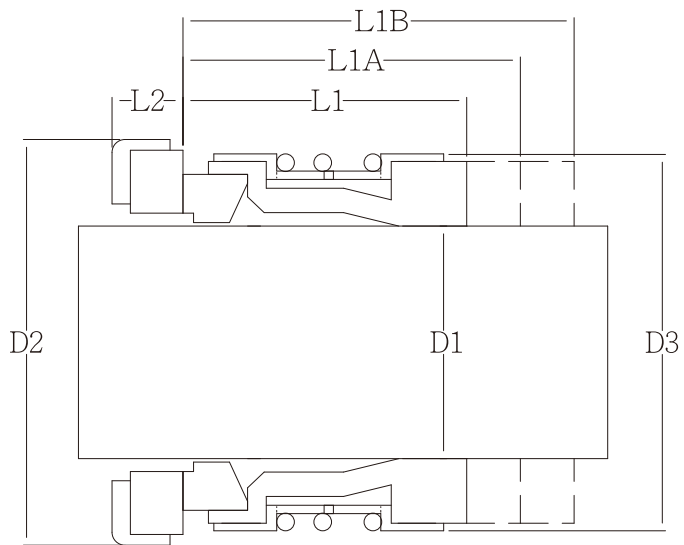

APPLICABLE MACHINES

Food and Beverage Processing,
Petrochemicals, Papermaking
Industry, Pharmaceuticals,
Wastewater Treatment,
Power Generation

ITEM NO	D1 SHAFT	D2 SEAT BORE	D3 HEAD O.D.	L1 HEAD HEIGHT	L1A HEAD HEIGHT	L1B HEAD HEIGHT	L2 SEAT HEIGHT
FULL SET SEALS	MM	MM	MM	MM	MM	MM	MM
FBA048MM	48.00	66.00	64.00	30.20	35.20	50.20	10.00
FBA050MM	50.00	70.00	66.00	30.20	37.70	50.20	10.00
FBA053MM	53.00	73.00	69.00	30.20	37.70	60.20	10.00
FBA055MM	55.00	75.00	71.00	30.20	37.70	60.20	10.00
FBA058MM	58.00	78.00	78.00	33.20	42.70	60.20	10.00
FBA060MM	60.00	80.00	80.00	33.20	40.70	58.20	12.00
FBA063MM	63.00	83.00	83.00	33.20	40.70	58.20	12.00
FBA065MM	65.00	85.00	85.00	33.20	40.70	68.20	12.00
FBA068MM	68.00	90.00	88.00	33.20	40.70	68.20	12.00
FBA070MM	70.00	92.00	90.00	33.20	48.20	68.20	12.00
FBA075MM	75.00	97.00	99.00	40.20	48.20	68.20	12.00
FBA080MM	80.00	105.00	104.00	40.20	47.70	77.70	14.00
FBA085MM	85.00	110.00	109.00	40.20	47.70	77.70	14.00
FBA090MM	90.00	115.00	114.00	40.20	52.70	77.70	14.00
FBA095MM	95.00	120.00	119.00	40.20	52.70	77.70	14.00
FBA0100MM	100.00	125.00	124.00	40.20	52.70	77.70	14.00

DIMENSION TABLE (MM SIZE)

MECHANICAL SEALS FOR PUMPS AND COMPRESSORS

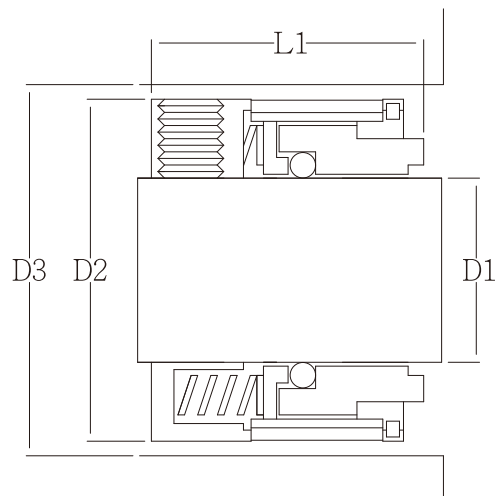

MAXIMUM SHAFT DIAMETER : 100MM

TEMPERATURE	-20°C~180°C(material-dependent)
MAX PRESSURE	200 PSI
MAX. SPEED	25 M/S

APPLICABLE
INDUSTRIES

Food & Beverage Processing,
Chemical Industry,
Marine and Shipbuilding,
Wastewater Treatment Systems

APPLICABLE
MACHINE

Water Pumps, Wastewater Pumps,
Heat Treatment & Water Circulation Pumps,
Chemical Pumps

ITEM NO	D1 SHAFT	D2 HEAD O.D.	D3 HEAD MIN. BORE	L1 HEAD HEIGHT
F8A0014M	14.00	24.00	26.00	23.00
F8A0016M	16.00	26.00	28.00	23.00
F8A0018M	18.00	32.00	34.00	24.00
F8A0020M	20.00	34.00	36.00	24.00
F8A0022M	22.00	36.00	38.00	24.00
F8A0024M	24.00	38.00	40.00	26.70
F8A0025M	25.00	39.00	41.00	27.00
F8A0028M	28.00	42.00	44.00	30.00
F8A0030M	30.00	44.00	46.00	30.50
F8A0032M	32.00	46.00	48.00	30.50
F8A0033M	33.00	47.00	49.00	30.50
F8A0035M	35.00	49.00	51.00	30.50
F8A0038M	38.00	54.00	58.00	32.00
F8A0040M	40.00	56.00	60.00	32.00
F8A0043M	43.00	59.00	63.00	32.00
F8A0045M	45.00	61.00	65.00	32.00
F8A0048M	48.00	64.00	68.00	32.00
F8A0050M	50.00	66.00	70.00	34.00
F8A0053M	53.00	69.00	73.00	34.00
F8A0055M	55.00	71.00	75.00	34.00

[illegible]

DIMENSION TABLE (MM SIZE)

F82A

MECHANICAL SEALS FOR
PUMPS AND COMPRESSORS

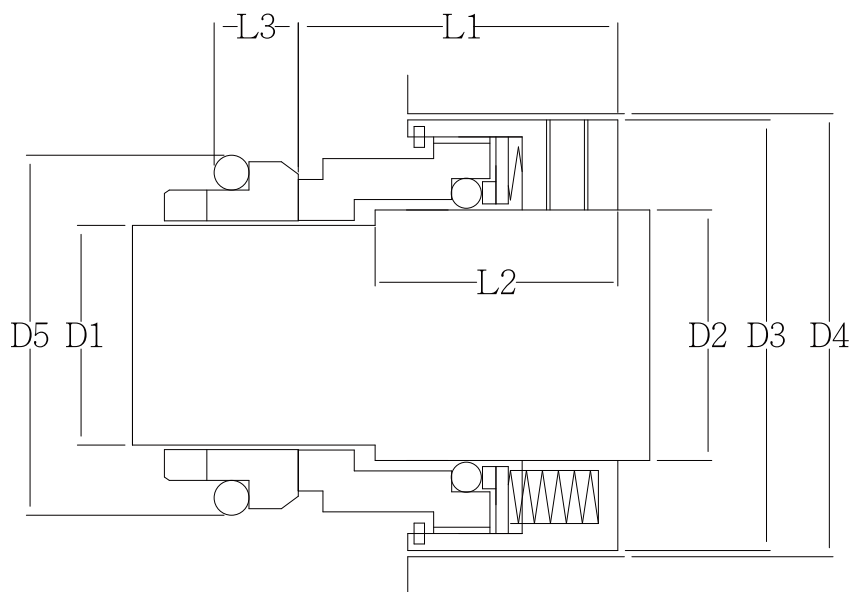

MAXIMUM SHAFT DIAMETER : 100MM

TEMPERATURE -20°C~300°C(material-dependent)

MAX.PRESSURE 900 PSI

MAX. SPEED 25 M/S

ITEM NO	D1 SHAFT	D2 SHAFT	D3 HEAD O.D.	D4 HEAD MIN. BOR	D5	L1 HEAD HEIGHT	L2 D2 SHAFT HEAD HEIGHT	L3 SEAT HEIGHT
F82A014M	14.00	18.00	32.00	34.00	25	30.50	24.50	10
F82A016M	16.00	20.00	34.00	36.00	27	30.50	24.50	10
F82A018M	18.00	22.00	36.00	38.00	33	31.50	25.00	11.5
F82A020M	20.00	24.00	38.00	40.00	35	31.50	25.00	11.5
F82A022M	22.00	26.00	40.00	42.00	37	31.50	25.00	11.5
F82A024M	24.00	28.00	42.00	44.00	39	34.20	27.50	11.5
F82A025M	25.00	30.00	44.00	46.00	40	34.50	27.50	11.5
F82A028M	28.00	33.00	47.00	49.00	43	37.50	30.00	11.5
F82A030M	30.00	35.00	49.00	51.00	45	38.00	30.00	11.5
F82A032M	32.00	38.00	54.00	58.00	48	38.00	30.00	11.5
F82A033M	33.00	38.00	54.00	58.00	48	38.00	30.00	11.5
F82A035M	35.00	40.00	56.00	60.00	50	38.00	30.00	11.5
F82A038M	38.00	43.00	59.00	63.00	56	39.50	29.50	14
F82A040M	40.00	45.00	61.00	65.00	58	39.50	29.50	14
F82A043M	43.00	48.00	64.00	68.00	61	39.50	29.50	14
F82A045M	45.00	50.00	66.00	70.00	63	39.50	29.50	14
F82A048M	48.00	53.00	69.00	73.00	66	39.50	29.50	14
F82A050M	50.00	55.00	71.00	75.00	70	44.00	32.50	15
F82A053M	53.00	58.00	78.00	83.00	73	44.00	32.50	15
F82A055M	55.00	60.00	80.00	85.00	75	44.00	32.50	15
F82A058M	58.00	63.00	83.00	88.00	78	49.00	37.50	15
F82A060M	60.00	65.00	85.00	90.00	80	49.00	37.50	15
F82A063M	63.00	68.00	88.00	93.00	83	49.00	37.50	15
F82A065M	65.00	70.00	90.00	95.00	85	49.00	37.50	15
F82A070M	70.00	75.00	95.00	104.00	92	55.50	42.00	18

STANDARD SEATS ALWAYS IN STOCK

SEAT TYPE LIST

S1

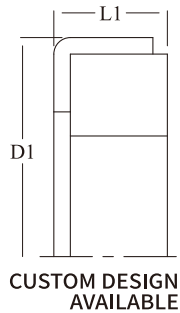

SEAL SIZE D	MATING RING	
	BORE D1	THICK L1
10	24	6.5
11	24	6.5
12	26	6.5
14	28	6.5
15	28	6.5
16	32	7.0
18	35	10.3
19	35	10.3
20	38	8.0
22	40	9
25	44	9
28	46	9
30	50	9
32	54	9
35	58	11
38	60	11
40	64	11
45	66	11
50	72	11

DIMENSION TABLE (MM SIZE)

S2-A

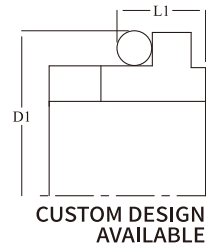

SEAL SIZE D	MATING RING	
	BORE D1	THICK L1
20	35	13
22	37	13
24	39	13
25	40	13
28	43	13
30	45	13
32	48	13
33	48	13
35	50	13
38	56	13
40	58	13
43	61	13
45	63	13
48	66	13
50	68	13
53	71	13
55	73	13
58	79	16
60	81	16
63	84	16
65	86	16
68	90	16
70	92	16
75	97	16
80	105	16
85	110	16

DIMENSION TABLE (MM SIZE)

S2-B

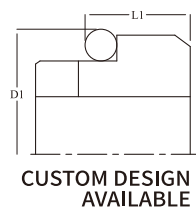

SEAL SIZE D	MATING RING	
	BORE D1	THICK L1
10	21	10
12	23	10
14	25	10
16	27	10
18	33	11.5
20	35	11.5
22	37	11.5
24	39	11.5
25	40	11.5
28	43	11.5
30	45	11.5
32	48	11.5
33	48	11.5
35	50	11.5
38	56	14
40	58	14
43	61	14
45	63	14
48	66	14
50	70	15
53	73	15
55	75	15
58	78	15
60	80	15
65	85	15
68	90	18
70	92	18
75	97	18
80	105	18.2
85	110	18.2

DIMENSION TABLE (MM SIZE)

S2-C

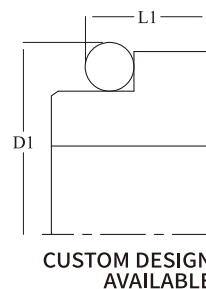

SEAL SIZE D	MATING RING	
	BORE D1	THICK L1
10	21	6.6
12	23	6.6
14	25	6.6
16	27	6.6
18	33	7.5
20	35	7.5
22	37	7.5
24	39	7.5
25	40	7.5
28	43	7.5
30	45	7.5
32	48	7.5
33	48	7.5
35	50	7.5
38	56	9
40	58	9
43	61	9
45	63	9
48	66	9
50	70	9.5
53	73	11
55	75	11
58	78	11
60	80	11
65	85	11
68	90	11.3
70	92	11.3
75	97	11.3
80	105	12
85	110	14

DIMENSION TABLE (MM SIZE)

S3

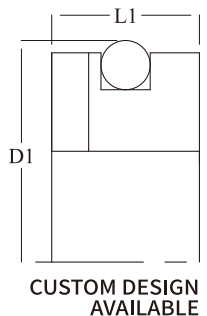

SEAL SIZE D	MATING RING	
	BORE D1	THICK L1
9.525	22.22	6
9.525	22.22	7.92
12.7	25.4	7.92
15.875	31.75	10.28
19.05	34.92	10.28
22.225	38.1	10.28
25.4	41.27	11.1
28.575	44.45	11.1
31.75	47.62	11.1
34.925	50.8	11.1
38.1	53.97	11.1
41.275	60.32	12.7
44.45	63.5	12.7
47.625	66.67	12.7
50.8	69.85	12.7
53.9	76.2	14.28
57.1	79.38	14.28
60.3	82.55	14.28
63.5	85.73	14.28
66.6	85.73	15.9
69.8	88.9	15.9
73	95.25	15.9
76.2	98.43	15.9
82.55	104.78	19.8
85.73	119.06	19.8

DIMENSION TABLE (MM SIZE)

S5

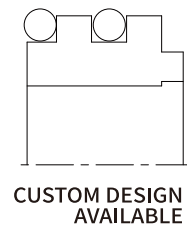

Shaft Mounted

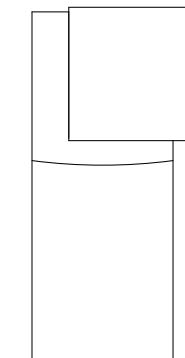

S4

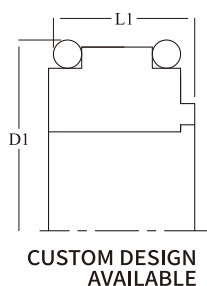

SEAL SIZE D	MATING RING	
	BORE D1	THICK L1
20	42	23
22	44	23
24	46	23
25	47	23
28	50	23
30	52	23
32	54	23
33	55	23
35	57	23
38	64	25
40	66	25
42	68	25
43	69	25
45	71	25
48	74	25
50	76	25
52	78	25
53	79	25
55	81	25
58	89	28
60	91	28
62	93	28
63	94	28
65	96	28
68	99	30
70	101	30
75	110	30
80	115	31
85	120	31

DIMENSION TABLE (MM SIZE)

Clamped-in

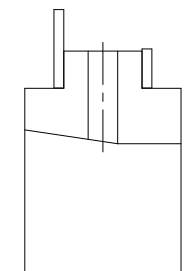

MECHANICAL SEAL MATERIAL COMBINATIONS

Mechanical Seal

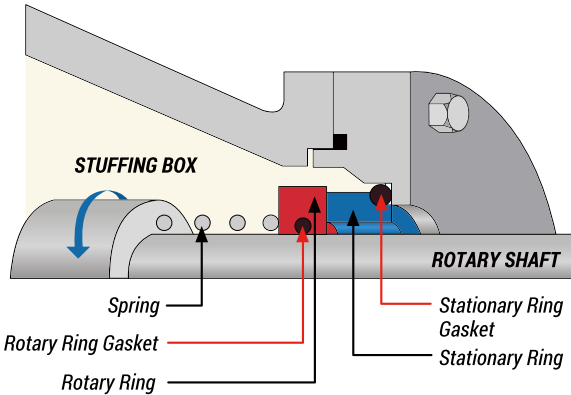

Our rubber factory specializes in producing high-quality rubber components with years of manufacturing expertise. We welcome small-volume orders and provide customized solutions to meet diverse customer needs. Count on us for reliable products and responsive service. **Contact us today to start a successful partnership!**

	FACE MATERIALS (rotary ring / stationary ring)		
CARBON	CARBON	C/M	Carbon resin bonded
		R1	Carbon graphite resin impregnated
		Q1	Carbon graphite antimony impregnated
	FACE MATERIALS (rotary ring / stationary ring)		
CARBIDE	SILICONE CARBIDES	Z	Reaction Bonded Silicon Carbide
		L	Sintered Silicon Carbide
		L3	Graphite Loaded Sintered Silicon Carbide
		L4	Porous Silicon Carbide
	TUNGSTEN CARBIDES	T	Co Tungsten
		T(N)	Ni Tungsten
		CERAMIC	J
	J1		Black Ceramic Coating
	J2		Ceramic(AL2O3) 95%



SPRING AND METAL CONSTRUCTION MATERIAL		
METAL	A	Bronze
	6	Sus316
	K	Sus304
	K1	Steel Coating
	K2	Ni Resist
	P	Crome Cast
	K7	Hastelloy
	K5	Am350
	MO	Monel Metal
	K4	Inconel 718
	K9	Dupex2205
	K6	Dupex2507
	K3	Titanium Alloy(T2)

GASKET		
RUBBER	H	Epdm R bber
	Y	HNBR Rubber
	V	Viton Rubber
	B	NBR Rubber
	G	Sic Rubber
	V1	Kalrez
	N	Neoprene



UL certification required,
please contact our sales team

GASKET		
TEFLON	F	Teflon(PTFE)
	FV	Teflon+Viton
	F1	Glass Filber 20% +Ptff
	F2	Glass Filber 20%+ 5%Carphite+PTFE



CIRCULATION SYSTEMS

API 610/682 PLAN



PLAN1

Internal circulation from the pump dis-charge to the seal

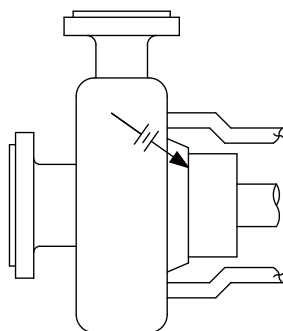

PLAN31

Circulation from the pump through a cyclone separator

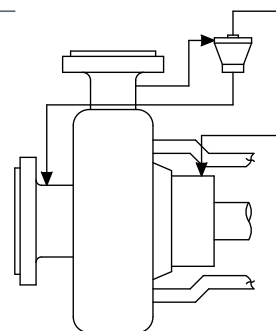

PLAN11

Circulation from the pump case through an orifice and to the seal

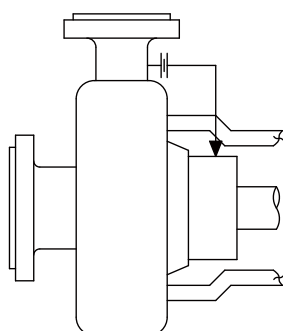

PLAN32

Injection of clean fluid into the seal chamber from an external source

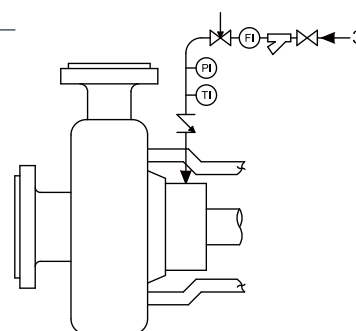

PLAN13

Circulation from the seal chamber, through an orifice and back to suction

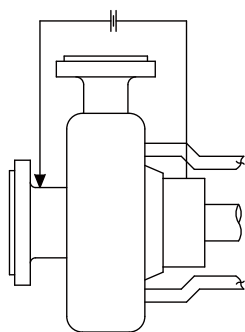

PLAN53A

External fluid reservoir pressurized, thermosiphon or forced circulation as required

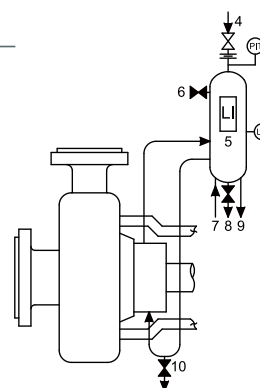

PLAN23

Circulation by means of a pumping ring from the seal through a cooler and back to the

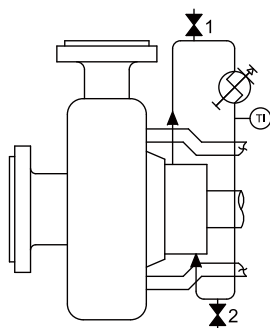

PLAN54

Circulation of clean fluid from an external system

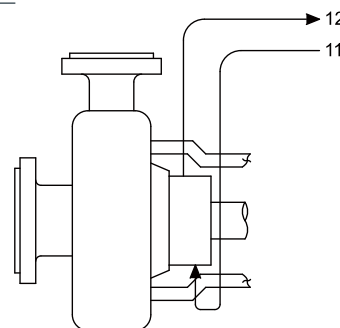

Orifice Plate

Normally Closed Valve

Normally Open Valve

Seal Cooler

Cyclone Separator

Y-Strainer

Check Valve

Thermometer

Flow Meter

Pressure Gauge

LI Level Indicator (LI)

PIT Local Pressure Transmitter (PIT)

LIT Local Level Transmitter (LIT)

1 Vent Outlet

2 Drain Outlet

3 External Flush Liquid

4 External Pressure

5 Reservoir

6 Barrier Fluid Filling Port

7 Cooling Water Inlet

8 Reservoir Barrier Fluid Drain Port

9 Cooling Water Outlet

10 Barrier Fluid Drain Port

11 External Fluid Inlet

12 External Fluid Outlet

粹 鋼 有 限 公 司
WESTSIDE LTD.

總公司

TAIPEI HEAD OFFICE

ADDRES 台灣台北市南港區忠孝東路六段185巷3弄1號2樓
2FL,NO3 Alley4 , Lane185 , Sec.6, Chung Shiao E Rd, Taipei ,Taiwan ,R.O.C

F A X 886-02-2785-9030

T E L 886-02-2785-7602

工廠

YULIN FACTORY

ADDRES 台灣雲林縣文科路1210號
No 1210, Wenke Rd Huwei Township

T E L 886-05-632-5612

服務處

SERVICE CENTER

ADDRES 高雄市苓雅區大順三路282巷73號
No. 73, Ln. 282, Dashun 3rd Rd., Lingya Dist., Kaohsiung , Taiwan (R.O.C.)

T E L 886-07-722-9263

C E L L 0933-026-303